

2/2 way solenoid valve normally closed

type 60A

pilot operated, DN 10mm, G3/8", body stainless-steel AISI304

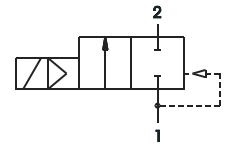

function A
(normally closed)

SPECIFICATION	
general	
type of construction	2/2-poppet valve, with diaphragm, normally closed NC, coil 360° rotatable
operator	solenoid
ports	G3/8
ambient temperature	-20 °C to +50 °C, higher allowed ambient temperatures on request
fluid temperature	dependent on sealing material and coil
viscosity	max. 21mm ² /s (cst) or 3°E
material	body and tube: stainless-steel inner parts: stainless steel, sealing: see type selection
mounting	2 threads M4 on the bottom side
installation	in any position, preferable vertical fixed solenoid coil
unit of supply	without connector
electrical data	
voltage	DC voltage or AC voltage
standard voltage	24V DC, 24V AC, 230V AC
special voltage on request	6V-207V DC, 12V-240V, 50Hz or 60Hz
acceptable voltage tolerance	+/- 10%
power consumption	see specifications at solenoid coils
coil type	temperature class F (155°C), winding class H (180°C)
duty cycle	100% ED (DB), continuous operation
protection class	IP65 according DIN EN 60529 (DIN 40050) with correctly mounted connector
pneumatic – hydraulic	
flow medium	all liquids and gases, which don't attack the used material
max. body housing pressure	PN 25 (bar)
response time	depending on operating pressure and fluid

2/2 way solenoid valve normally closed

type 60A

pilot operated, DN 10mm, G3/8", body stainless-steel AISI304

type 60A, normally closed					
type * (order-nr.)	DN (mm)	ports	maximum differential pressure in bar **		kv-value (m ³ /h)
			coil E1AA		
			~ (50Hz)	= (DC)	
60A - 3 - A....	10	G3/8	0,02 – 12	0,02 – 10	1,7

* Type designation (order-nr.) must be completed with sealing material, coil and supply voltage.

** At DC voltage all pressure specifications apply to a fluid temperature up to 80 °C. At higher fluid temperatures, the maximum differential pressure will be reduced by 0,4% / °C. Valves are suitable for vacuum.

sealing material	Code	fluid temperature	applicable for	standard voltage	Code
NBR (Perbunan)	B	max. 80°C	neutral gases and liquids	24V = DC	02400
EPDM	E	max. 130°C	hot water, steam, not for oil and grease	24V ~ (50Hz)	02450
FPM	V	max. 130°C	oil, petrol, oxygen	230V ~ (50Hz)	23050

coil power consumption at 20 °C, protection class, interface					
coil type	inrush power ~ (50Hz) VA	rated power ~ (50Hz) VA	power = (DC) (W)	protection class with/without connector	interface
E1AA	32	14	12	IP65 / IP00	Connector DIN EN 175301-803 (DIN 43650) type A

ORDER CODE	60 A - 3 B - A E1AA 02400				
	type	function	ports	seal material	supply voltage coile type short circuit ring
type	type 60				
function	A = normally closed				
ports	3 = G3/8				
seal material	B = NBR (Perbunan), E = EPDM, V = FPM				
short circuit ring	A = copper short circuit ring, X = without short circuit ring				
coil type	see specifications of the particular coil				
supply voltage	always 5-digit, see code of standard voltage				

2/2 way solenoid valve normally closed

type 60A

pilot operated, DN 10mm, G3/8", body stainless-steel AISI304

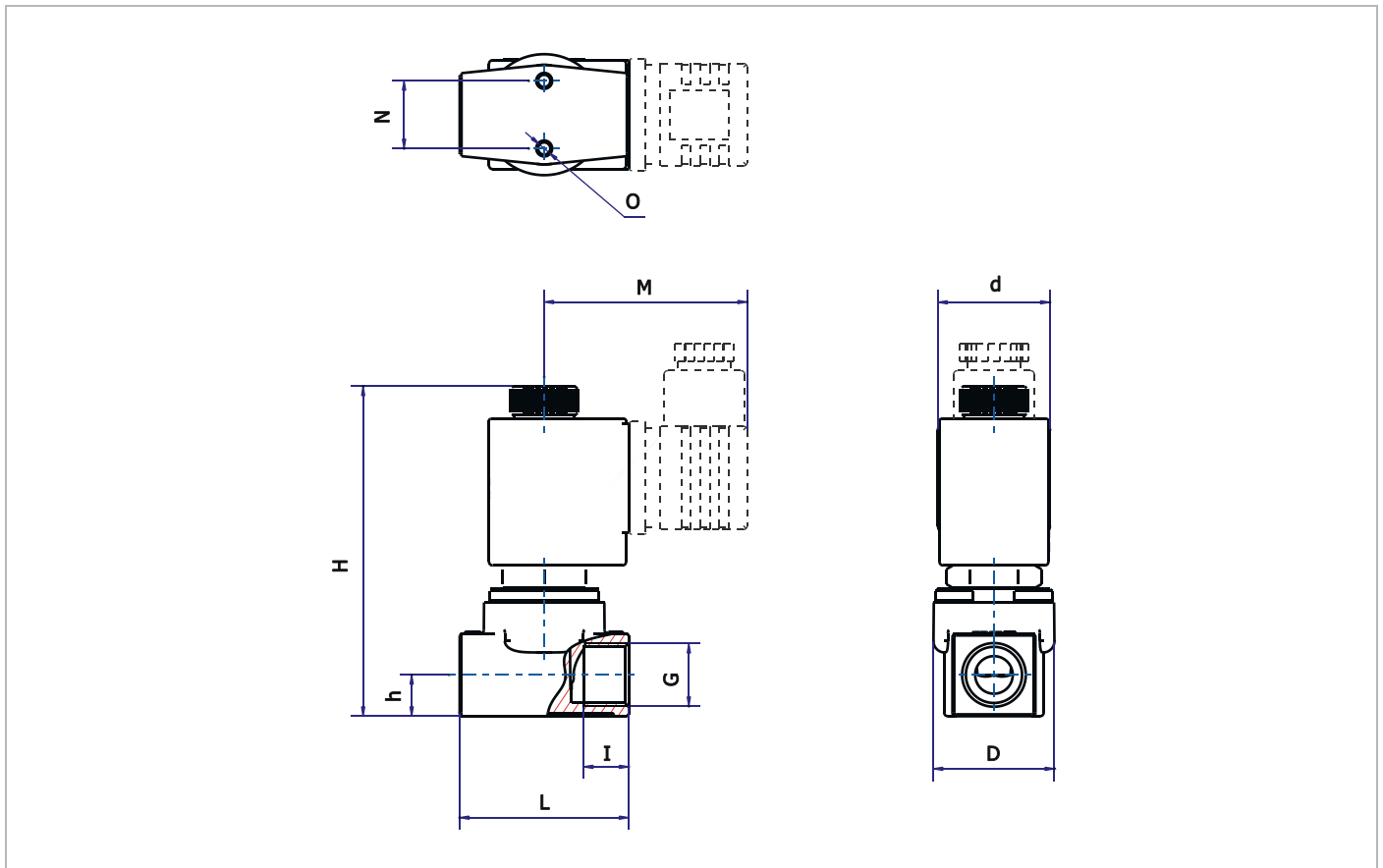

Dimension tale for type 60A in mm, weight approx. in kg

type	G	d	D	h	H	I	L	M	N	O	weight (kg)
60A-3.-AE1AA	G3/8	30	32,5	11	88	12	45	54	18	M4	0,36